



## S ROUND END PLATE DOOR FURNITURE PLATE CYLINDER HOLE 50 LEVER

### DETAILS

#### PRODUCT CODE

S0250SSS

#### DIMENSIONS

165mm x 46mm

#### DOOR THICKNESS

Suits 32-50mm Doors

#### FIXING

Visible

#### HANDING

Non-Handed

#### MATERIAL

304 Grade Stainless Steel

#### OVERALL THICKNESS

11.5mm

#### PRODUCT SERIES

S Round End Plate Door Furniture

#### WARRANTIES

25 Years Mechanical

#### NOTES

Product code identifies SSS finish

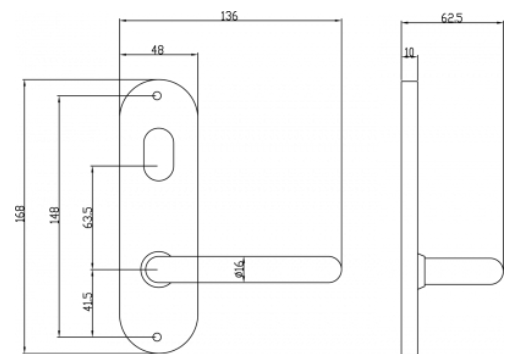

### FINISHES

Polished Stainless Steel (PSS)

Satin Black (SBL)

Satin Antique Bronze (SABZ)

Satin Antique Brass (SAB)

Satin Stainless Steel (SSS)

Gun Metal (GM)

Satin Nickel (SN)

Satin Gold (SG)

Polished Gold (PGL)

### CERTIFICATIONS

