



S ROUND END PLATE DOOR FURNITURE PLATE HOSPITAL TURN 50 LEVER

DETAILS

PRODUCT CODE
S08H50

DIMENSIONS
165mm x 46mm

DOOR THICKNESS
Suits 32-50mm Doors

FIXING
Visible

HANDING
Non-Handed

MATERIAL
304 Grade Stainless Steel

OVERALL THICKNESS
11.5mm

PRODUCT SERIES
S Round End Plate Door Furniture

WARRANTIES
25 Years Mechanical

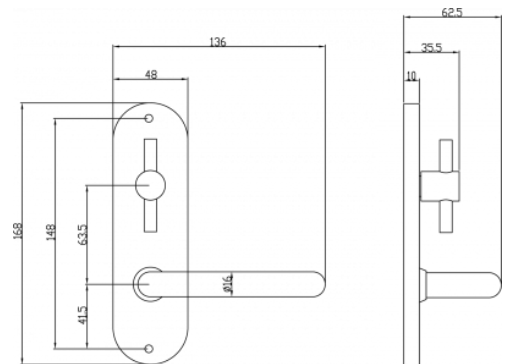

FINISHES

Polished Stainless Steel (PSS)
Satin Black (SBL)
Satin Antique Bronze (SABZ)
Satin Stainless Steel (SSS)
Gun Metal (GM)
Satin Gold (SG)

CERTIFICATIONS

