



## S ROUND END PLATE DOOR FURNITURE PLATE CYLINDER HOLE 50 LEVER

### DETAILS

#### PRODUCT CODE

S0250

#### DIMENSIONS

165mm x 46mm

#### DOOR THICKNESS

Suits 32-50mm Doors

#### FIXING

Visible

#### HANDING

Non-Handed

#### MATERIAL

304 Grade Stainless Steel

#### OVERALL THICKNESS

11.5mm

#### PRODUCT SERIES

S Round End Plate Door Furniture

#### WARRANTIES

25 Years Mechanical

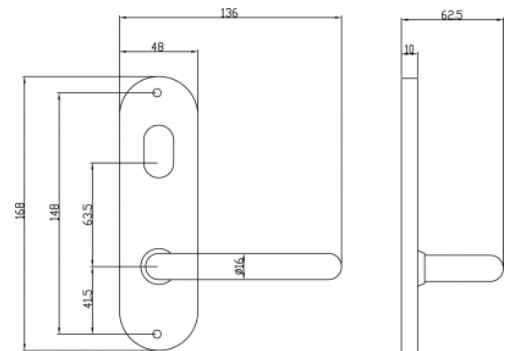

### FINISHES

Polished Stainless Steel (PSS)

Satin Black (SBL)

Satin Antique Bronze (SABZ)

Satin Stainless Steel (SSS)

Gun Metal (GM)

Satin Gold (SG)

### CERTIFICATIONS

